

NOTE: LEDGER MAY BE USED ON ONE  
OR BOTH SIDES OF BOND BEAM

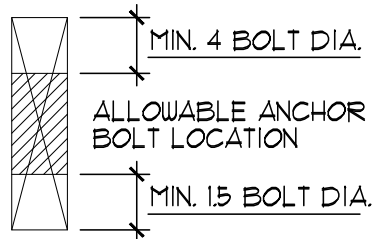

ANCHOR BOLT SPECIFICATION

DIAMETER = \_\_\_\_\_

LENGTH = \_\_\_\_\_

SPACING = \_\_\_\_\_

9

LOAD BEARING LEDGER WITH TRUSS TOP CHORD SUPPORT

SCALE: NTS